

PROJECT:  
 COMMUNITY GARDENS  
 COMMUNITY GARDENS  
 500 SCHOOL STREET  
 MANSFIELD, MA 02048

PROJECT NUMBER: 19195



STAMP:

ISSUE: PRELIMINARY DATE: 06.16.2020

DRAWING SCALE: 1/16" = 1'-0"

DRAWN BY: CJD CHECKED BY: DMC

DRAWING TITLE: FLOOR PLANS

DRAWING NUMBER:

**A1.0**

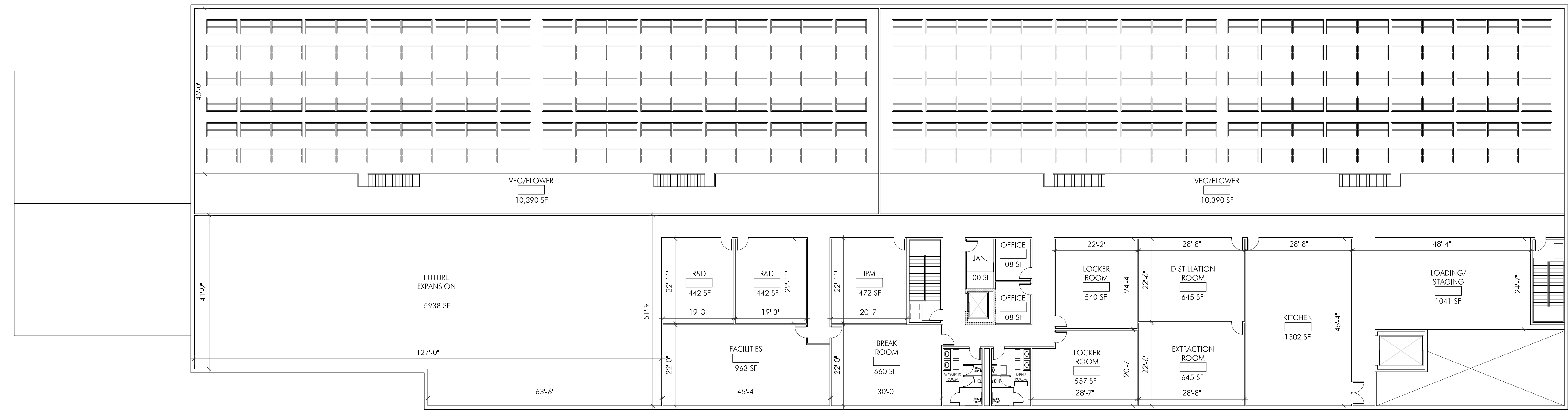

SQUARE FOOTAGE CALCULATIONS

FIRST FLOOR:	44,016 SF
MEZZANINE:	8,272 SF
SECOND FLOOR:	19,272 SF
TOTAL PROPOSED:	71,560 SF

